

Procédés Hallier Collection

◉ **Mini LED spotlight** 1W or 2W

Spotlight

NANO



A tool at the service of professionals



Made in France

Designer - Manufacturer

www.procedeshallier.fr



Procédés Hallier Collection

► Mini LED spotlight 1W or 2W

Spotlight

NANO



► Technical data

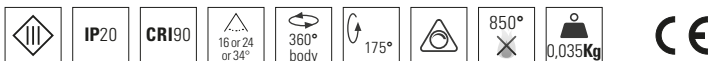

Power: 1 W or 2 W

CRI 90 in 3000 K and in 4000 K

External LED driver (not included)

Voltage In:

220 to 240 V, AC 50-60 Hz

output current 350 mA for 1 W or 700 mA for 2 W

Beam angle 16° or 24° or 34° to select (possibility to swap yourself)

Material: Aluminium / Steel

Finish: Black or Grey anodizing

► Dimensions (mm)

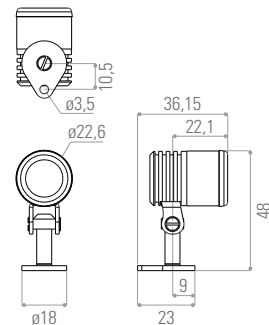

► Options

BLUETOOTH controlled by iPhone, computer or dimmable bluetooth power switch ENOCEAN

Standard LED driver

Electric connector

Dimmable

Other colors available on request (powder paint)

► Installation

Fastening rod (as picture)

Other option available on request

► Photometry

NANO 3000 K 2 W 700 mA CRI 90

16°

Distance (cm)	Beam Diameter (cm)	lux
0,3m	(ø13cm)	7100
0,5m	(ø22cm)	3400
1m	(ø44cm)	1025
1,5m	(ø66cm)	325

24°

Distance (cm)	Beam Diameter (cm)	lux
0,3m	(ø20cm)	5500
0,5m	(ø33cm)	2650
1m	(ø67cm)	700
1,5m	(ø100cm)	260

34°

Distance (cm)	Beam Diameter (cm)	lux
0,3m	(ø24cm)	5100
0,5m	(ø41cm)	2040
1m	(ø81cm)	580
1,5m	(ø121cm)	210

Measures taken from right in the front of the spotlight



Made in France

Factory & Head office : 69, rue Victor Hugo 93100 MONTREUIL - FRANCE

Tel. +33 (0)1 48 51 79 88 • contact@procedeshallier.fr

